

**BAUPROJEKTE
 PROJECTS**

Auswahl/selection

Germany Munich,
BMW Motorcycle Center and Subsidiary
 2009; 62,100 sqm

Germany Munich, *Munich Airport – Midfield Terminal*
 2009; 225,000 sqm

Germany Munich, *Munich Airport Terminal 2 Extension*
 2009; 11,400 sqm

Germany Munich,
Rehabilitation Siemens Residential Estate
 2009; 6,360 sqm

Greece Athens, *Athens International Airport,
 New Multi-storey Car Park Building*
 2009; 13,840 sqm

Germany Munich, *Thuringia Generali Office Building*
 K+P in association with RKW, Dusseldorf
 2008; 16,000 sqm

Germany Würzburg, *University of Würzburg
 New Chemical Center and Research Facilities*
 2008; 8,150 sqm

Czech Republic Chomutov, *PULS Factory A*
 2006; 6,400 sqm

Austria Schwaz, *Paulinum Episcopal Grammar School*
 2005; 7,500 sqm

Germany Berlin, *Airport Berlin-Schönefeld – Terminal D*
 2005; 10,400 sqm

**STÄDTEBAULICHE PROJEKTE
 URBAN PLANNING PROJECTS**

Auswahl/selection

Germany Laufen, *Reconstruction of the Old Town*
 2009; Preparatory studies and supervision of the reconstruction process

Germany Munich, *Technology Park Munich Fair West*
 2009; Urban planning design and legally binding land use plan

PR China QinHuangDao, *Western Coastal Region*
 2007; Regional and urban planning competition, 1st prize

PR China Qingdao, *Laoshan and Huang Dao*
 2005; Urban planning competition, 1st prize and Masterplan

Russia Moscow, *Lefortovo*
 2004; Urban planning competition, 2nd prize

**WETTBEWERBE UND GUTACHTEN
 CONTESTS AND REPORTS**

Auswahl/selection

Croatia Zagreb, *Zagreb International Airport*
 2008; Competition management, Interior design

Kingdom of Saudi Arabia Al-Madinah,
Airport Refurbishment and extension
 2008; Design and build proposal, 1st prize

Romania Suceava, *Suceava Airport*
 2008; Development study, Master plan study

PR China Urumqi, *International Airport – New Terminal 2*
 2007; Design competition, 2nd prize

PR China Hangzhou, *Xiaoshan International Airport,
 New Terminal 3 and Long-term Expansion*
 2005; Design competition, 2nd prize

PR China Weifang, *Weifang Government Building No 2*
 2005; Design competition, 2nd prize

Russia Moscow, *Vnukovo International Airport,
 Multi-storey Car Park Building*
 2004; Planning study

**ARCHITEKTURPREISE
 ARCHITECTURAL AWARDS**

Auswahl/selection

2008 – 2010
 Deutscher Bauherrenpreis 2009/2010
 Bayerischer Bauherrenpreis 2009

dena – German Energy Agency Award 2009
 Design Award of Wüstenrot Stiftung 2008
 Germany; Rehabilitation Siemens Residential Estate

2009 German Sustainable Building Certification in Silver
 Germany; Thuringia Generali Office Building

2004 – 2005
 European Award for Steelstructures 2005
 German Award for Steelstructures 2004
 Europe; Munich Airport Terminal 2

K+P Koch + Partner Architekten und Stadtplaner

OFFICE MUNICH

Ismaninger Straße 57
 D-81675 München
 Phone +49 (0)89. 411 88-0
 Fax +49 (0)89. 411 88-200
 info@kochundpartner.de
 www.kochundpartner.de

OFFICE LEIPZIG

Wittstockstraße 5
 D-04317 Leipzig
 Phone +49 (0)341. 269 27-0
 Fax +49 (0)341. 269 27-20

K+P Koch + Partner | Munich, Leipzig

Koch + Partner besteht seit mehr als 35 Jahren aus einem interdisziplinären Team von Architekten, Stadt- und Raumplanern, Bauingenieuren und Innenarchitekten. Koch + Partner, QM-zertifiziert nach ISO 9001:2000, ist als erfahrenes und leistungsfähiges Team über die Grenzen Deutschlands tätig. Das Leistungsspektrum erstreckt sich über alle Planungsstufen. Ergänzt durch ein Projektmanagement werden sämtliche Planungsleistungen auch als „Generalplaner“ für alle Fachingenieurleistungen übernommen. Planungsschwerpunkte sind Verkehrsbauten, Verwaltungsgebäude, Schulen, Bauten der Wissenschaft und Technik, Energieeffiziente Gebäude, Struktur- und Entwicklungsplanung, Bauleitplanung, Altstadtsanierung und Bauen im Bestand.

Koch + Partner, comprises for more than 35 years an interdisciplinary team of architects, urban and regional planners, building and civil engineers and interior designers. Koch + Partner, quality management system certified according to ISO 9001:2000, are an efficient and experienced planning team, that is also active beyond the borders of Germany. They are involved in all stages of the planning process. Enhanced by a project management K+P also takes over all planning for specialist engineering services as “general planners”. Focal points of planning include traffic, administration and office buildings, schools, buildings for science and technology, energy-efficient buildings, structure and development planning, urban development planning and old town refurbishment, as well as working with existing buildings.



**Reg.-Baumeister,
 Dipl.-Ing. Architect BDA
 Norbert Koch**

Graduate architectural engineering, member of BDA, studies of Architecture and Urban planning at University of Technology, Munich; 1967–72 Head of Institute for Urban, Regional and Environmental Planning; since 1970 own architectural and urban planning practice

**Dipl.-Ing. Architect BDA
 Wolfgang Voigt**

Studies of Architecture at University of Technology, Munich; 1977 Diploma at University of Technology, Munich; since 1977 at K+P, Munich; since 1988 in partnership

**Dipl.-Ing. Architect BDA
 Jürgen Zschornack**

1984 Diploma at University of Technology, Munich; since 1985 Koch + Partner, Munich; 2001–05 as project partner; since 2006 in partnership; since 2006 member of the IHK-foreign trade and payments committee

www.kochundpartner.de

Koch + Partner verfügt über ein qualifiziertes Team. Unsere langjährigen Mitarbeiterinnen und Mitarbeiter haben wertvolle Erfahrungen und besondere Kenntnisse im In- und Ausland erworben. Wir sind prädestiniert dafür, bei internationalen Großprojekten in interdisziplinären Arbeitsgemeinschaften mitzuwirken oder als Generalplaner das Planungsteam zu führen. Bei Auslandsprojekten arbeiten wir grundsätzlich mit lokalen Partnern zusammen.

Lange bevor Begriffe wie Nachhaltigkeit und Ressourcenschonung die öffentliche Diskussion beherrschten, haben wir bei unseren Projekten energieeffiziente Architektur und ökologisches Bauen umgesetzt. Unser Leistungsspektrum erstreckt sich über alle Phasen eines Bauprojekts. Wir begleiten unsere Partner vom Projektmanagement über die Beratung in der Frühphase des Baus bis hin zur Bauleitung. Eine interne Qualitätskontrolle sichert den geregelten Planungsverlauf und ist seit jeher Bestandteil der Planung in allen Leistungsphasen.



2



3



4

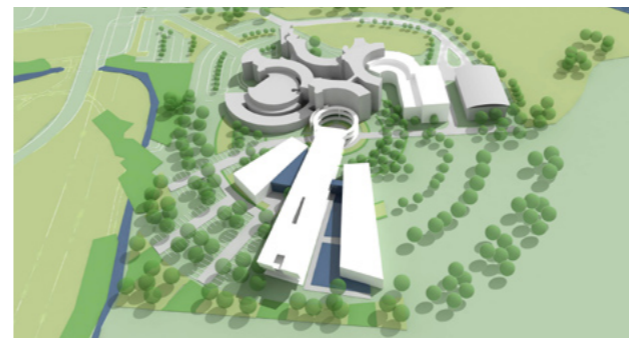

5

6

7



8

Koch + Partner has a highly trained team at its disposal. Our employees, who have been with the company for many years, have invaluable experience and knowledge acquired both in Germany and abroad. We are ideally qualified to collaborate in interdisciplinary working groups on major international projects and to lead the planning teams as general planners. In projects outside Germany we work together with local partners.

Long before concepts like sustainability and the responsible use of resources entered the public debate, we were already using energy-efficient architecture and eco-friendly building methods. Our services extend to all phases of a construction project. We assist our partners with project management, consulting during the early phase of construction, and construction management. The internal quality control ensures a regulated planning process and is at all times part of all planning phases.

- 1+2 **Munich Airport Midfield Terminal** Germany (Munich); 2008/09
- 3 **Munich Airport Terminal 2** Germany (Munich); 2003
- 4 **Munich Airport Multi-storey Car Park Building P20** Germany (Munich); 2003
- 5 **PULS Power GmbH, New Factory A** Czech Republic (Chomutov); 2006

- 6 **Rehabilitation Siemens Residential Estate** Germany (Munich); 2009
- 7 **Extension of the ESO Headquarters Garching** Germany (Garching); 2007
- 8 **QinHuangDao Western Coastal Region, Masterplan for New City** China (QinHuangDao); 2007